



Service Manual

Dishwasher ADP 741 WH

Model Version		Page
	ADP 741 WH 8542 741 64000	
	Technical data	2 - 3
	Spare part list	4 - 5
	Exploded view	6 - 8
	Wiring diagram	9
	Circuit diagram	10
	Program diagram	11
	Family	Standard Range AS1

Technical data

Dimension

Height	85,0	cm
Width	59,4	cm
Depth	60,0	cm
Weight	49,8	kg

Specification / PI-Expression

Water consumption	26,0	l
Energy consumption	1,8	kWh
Program step	~ 89	min
Noise level		
- without door insulation	~ 60	dB (A)
- with door insulation	~ 58	dB (A)
Detergent	25-75	ml
Separate contained		
- chamber I	1/3	
- chamber II	2/3	
Salt consumption		
by 21° dh max.	83	g
Water connection	25	°C
Capacity	12	stand. place settings

Volume

Water		
Working level	5,6	l
Safety level	11,0	l
Overflow-level	13,7	l
Detergent max.	75	g
Clear rinse	130	cm ³
6 Dossier steps	1-6	cm ³
Salt container	2	kg

Flow Rates / Inlet Volumes

Spray pump	70	l / min
Drain pump	13,6	l / min
Height of drain hose max.	1,1	m
Length of drain hose max.	4	m
Water inlet electrovalve	5,0 ± 5%	l

Water Pressure

Inlet pressure	1-10	bar
Spray pump pressure	0,37	bar

Rotations

Spray pump - motor	2780	RPM
Drainpump - Motor	3000	RPM
Spray arm lower	48 ± 6	RPM
Spray arm upper	22 ± 6	RPM

Electrical Data

Base level		
Voltage	220/230	V
Frequency	50	Hz
Total power	~ 2,2	kW
Fuses	10	A
Water connection up to	25	°C

Timer

Model	EC 4649.01
Basic step time	15 s
4 Normal times	30/60/120/270 s
2 Complem. times	45/105 s

Heating

1 Element system

Voltage	220/240	V
Power consumption	2200	W
Resistance	~ 25,0	Ω

Motor

Spray pump - motor

Voltage	220	V
Power consumption	130	W
HI	121	Ω
HA	30	Ω
Capacitor	3	μ F

Drainpump - motor

Voltage	220/240	V
Power consumption	30	W
Resistance	144	Ω

Timer motor

Voltage	220/240	V
Resistance	5,64+0,4	kΩ

Valves

Inlet valve

Voltage	220/240	V
Resistance	3820	Ω

Technical data**Regeneration valve**

Voltage	220/240	V
Power consumption	8	W
Resistance	2950	Ω

Thermostats**Thermostat 65°C with white colour indication**

Switching on temperature	68 ± 3	°C
Switching off temperature	57 ± 5	°C

Reset safety thermostat

Switching on temperature	85+5/-3	°C
Switching off temperature	with manual reset	

Water Levels**Basic-/Working level (in mm water column)**

Switching point	140 ± 3	mm w.c.
Reset point	40 ± 5	mm w.c.

Safety level

Switching point	151 ± 3	mm w.c.
Reset point	100 ± 5	mm w.c.

Water Measuring

Basic-/Working level	125	mm
Safety level (~10 l)	136	mm

Regeneration and Volumes

Volume	360	cm ³
Waterhardness	< 30*	dh

Spare part list

Model ADP 741 WH
Service No. 854274164000
Version 854274164000

Pos. No.	12NC Code	Description	Pos. No.	12NC Code	Description
001 1	4812 404 48578	Bracket foot	480 1	4819 466 98512	Cover of cable
011 0	4812 505 18006	Foot short, adjustable	480 3	4812 290 48003	Cable separator
030 0	4812 310 18279	Table top cpl. WH	491 0	4812 290 68051	Terminal block
034 0	4812 404 78087	Pin	501 0	4819 282 18721	Timer EC4649.01
034 1	4812 404 78088	Fastener	551 0	4819 282 48198	Thermostat 65 degree
040 0	4812 417 18309	Hinge set	564 0	4819 282 48315	Thermostat safety
040 1	4812 417 18311	Cover,hinge set	564 1	4819 404 79292	Holder
044 0	4812 492 38011	Spring f.door left	564 2	4819 532 68811	Gasket
044 1	4812 492 38012	Extension f. spring	571 0	4812 281 28059	Valve,magnet inlet
044 2	4812 492 38013	Spring f. door right	575 0	4819 281 28184	Valve,magnet regen.
045 0	4812 404 48114	Brake f.door	581 0	4819 271 29004	Pressostat
045 1	4812 401 18079	Band,brake	633 0	4819 273 18252	Microswitch door
045 2	4812 401 18081	Hoop connection	680 0	4812 418 68119	Combidosage
053 0	4812 440 88023	Plinth sheet	680 1	4819 468 18253	Gasket set
053 1	4812 440 18597	Pedestal cover ri+le WH	681 0	4812 462 78311	Threaded cap
053 2	4812 440 18584	Plinth middle part WH	681 1	4812 466 68444	Gasket cover set
103 0	4812 440 18179	Door outer WH	682 0	4812 466 68445	Gasket cover set
120 0	4812 440 18474	Door,inner	701 0	4812 530 28081	Hose, inlet 3/8Z cpl. 5m
121 0	4812 404 48577	Batten cpl.	701 0	4812 530 28082	Hose, inlet 3/8Z cpl. 3m
130 0	4812 417 58019	Tilt lock	701 0	4819 530 28283	Hose, inlet 2m
131 0	4819 401 18831	Hook lock	701 1	4812 310 18153	Yoke clamp set
191 0	4812 466 68408	Gasket door	701 2	4822 480 50159	Sieve inlet
191 1	4812 466 68164	Gasket door, inner	710 0	4812 418 68108	Monoblock
192 0	4812 466 68163	Gasket door, lower	710 1	4819 360 58381	Floater
200 0	4812 418 18042	Container insulated	710 2	4819 310 38536	Nut threaded ring set
200 1	4819 535 78066	Fastener container	710 3	4819 466 69562	Gasket set
241 0	4819 458 68053	Basket upper straight GR	714 0	4819 462 78885	Threaded cap
241 1	4819 404 79343	Holder cup GR	716 0	4812 418 68115	Reg.dosage set
241 3	4819 528 78104	Wheel,basket upper (set) GR	716 1	4819 466 69037	Gasket
242 0	4819 458 68109	Basket lower cpl. GR	716 2	4819 462 78504	Can plug
242 1	4819 528 78105	Wheel,basket lower GR	721 0	4819 535 88105	Hub lower cpl. GR
242 2	4819 458 68111	Holder plate GR	721 1	4819 535 98619	Arm,spray lower cpl. GR
243 0	4819 458 68046	Basket cutlery	721 2	4819 505 18357	Nut coupling GR
261 0	4819 462 38271	Rail telescope, inner	721 3	4819 505 18354	Nut
261 1	4819 462 79968	Cap rail GR	721 4	4819 466 69398	Gasket lower
261 2	4819 462 79969	Cap rail ahead GR	721 5	4812 502 18021	Nut rotor lower
263 0	4819 520 18013	Ball cage cpl.	722 0	4819 535 98621	Arm,spray upper GR
263 1	4812 520 48001	Ball Niro 8 D	722 2	4819 535 88107	Bearing rotor hub GR
301 0	4812 453 78377	Control panel WH	722 3	4819 466 69396	Gasket
303 0	4812 460 58019	Grip WH	722 4	4819 466 69399	Gasket upper
322 0	4819 460 78604	Insert panel WH	723 0	4819 360 69675	Set of nozzles GR
331 0	4819 412 58646	Knob program WH	723 1	4819 466 68908	Gasket
400 0	4812 361 58007	Motor w.spray pump cpl.	725 0	4819 532 88044	Funnel GR
405 0	4812 360 18014	Spray pump	726 0	4812 530 28746	Hose
405 1	4819 515 28158	Gasket	726 1	4819 530 28539	Drainhose inner connecting
405 2	4819 466 69401	Gasket	726 2	4819 530 28538	Hose bow
405 3	4819 440 19139	Cap	751 0	4812 418 18043	Water collector
420 0	4812 121 18129	Capacitor	751 1	4819 515 28157	Tube,stabilizer cpl.
421 0	4819 121 18063	Interf.filter	753 0	4812 530 28095	Suction pipe set
430 0	4812 360 18022	Pump,draining cpl.	753 1	4812 530 28736	Chamber,air
450 1	4819 532 68332	Nut	755 0	4812 530 28094	Bend
450 3	4819 404 79291	Support	755 1	4819 404 49567	Holder thermostat
450 4	4819 530 28996	Tube	761 0	4812 480 58048	Sieve fine
451 0	4819 259 28903	Tube,heating	761 1	4819 532 68331	Gasket
480 0	4819 320 58321	Cable harness	762 0	4819 480 58084	Microfilter

Spare part list

Model ADP 741 WH
Service No. 854274164000
Version 854274164000

Pos. No.	12NC Code	Description
763 0	4812 480 58049	Sieve coarse
781 0	4812 530 28737	Hose,draining
781 2	4819 492 68405	Clip f.non-return valve
781 3	4812 360 58095	Flap f.non-return valve
783 0	4812 530 28097	Hose
783 1	4819 530 28997	Hose
783 2	4819 530 28998	Hose
783 3	4819 530 28999	Hose
783 7	4819 530 29002	Hose
794 1	4819 468 18254	Gasket
901 0	4819 401 18808	Strap 30 mm
901 1	4819 401 18809	Strap 17,5 mm
901 2	4819 401 18811	Strap 47 mm
901 3	4819 401 18821	Strap 130-150
901 4	4819 401 18813	Strap 82 mm
901 5	4819 401 18814	Strap 42,5 mm
901 6	4819 401 18815	Strap 60 mm
901 7	4819 401 18816	Strap 13,5 mm
901 8	4819 401 18812	Strap 8 mm
902 2	4812 290 48007	Strain relief
903 0	4819 466 68905	Striker door
910 0	4819 502 18464	Screw
910 1	4812 502 18019	Screw
964 0	4812 460 58096	Tape,sealing
993 0	4812 530 48017	Bow
993 5	4822 532 80216	Funnel salt

Exploded view

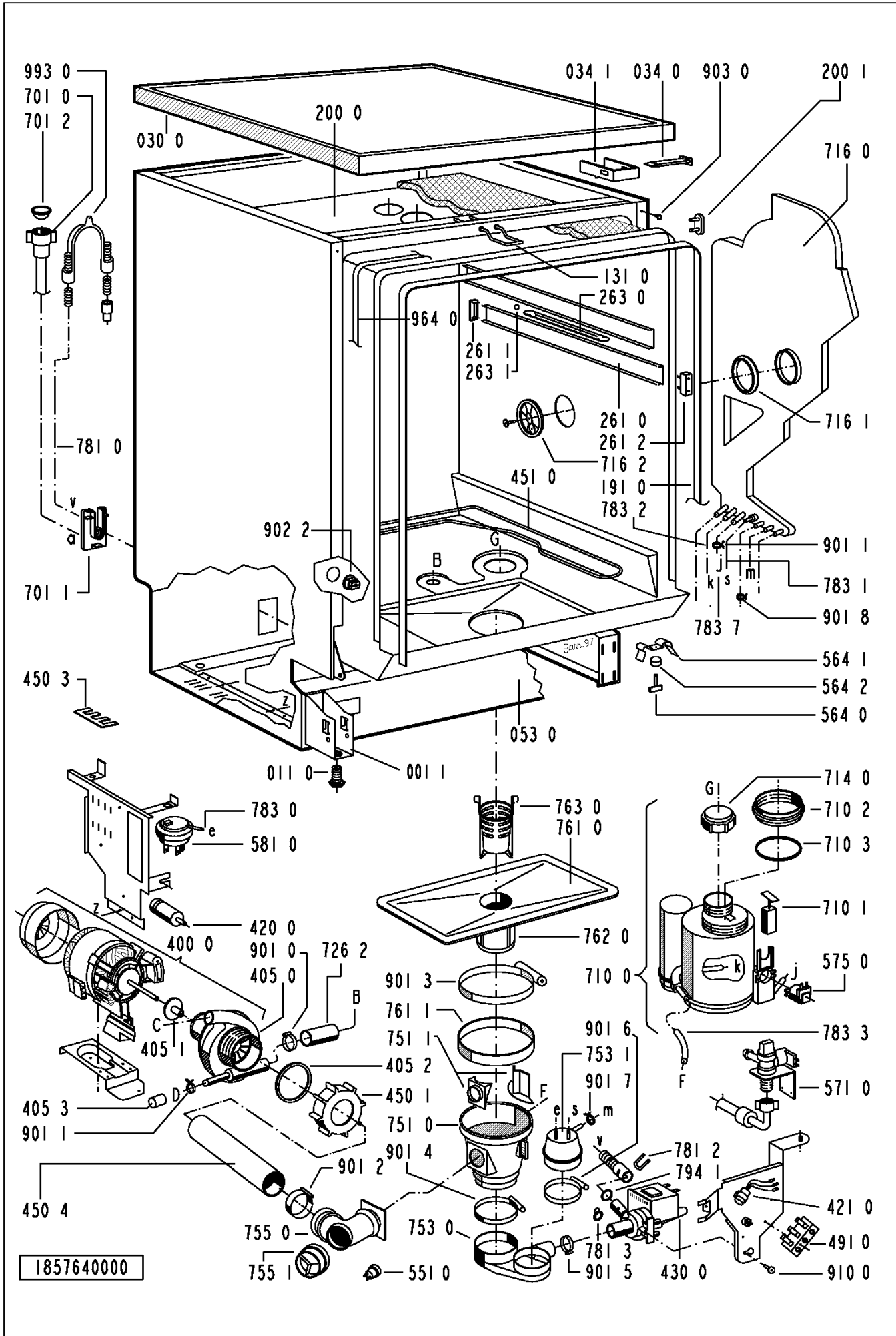

Exploded view

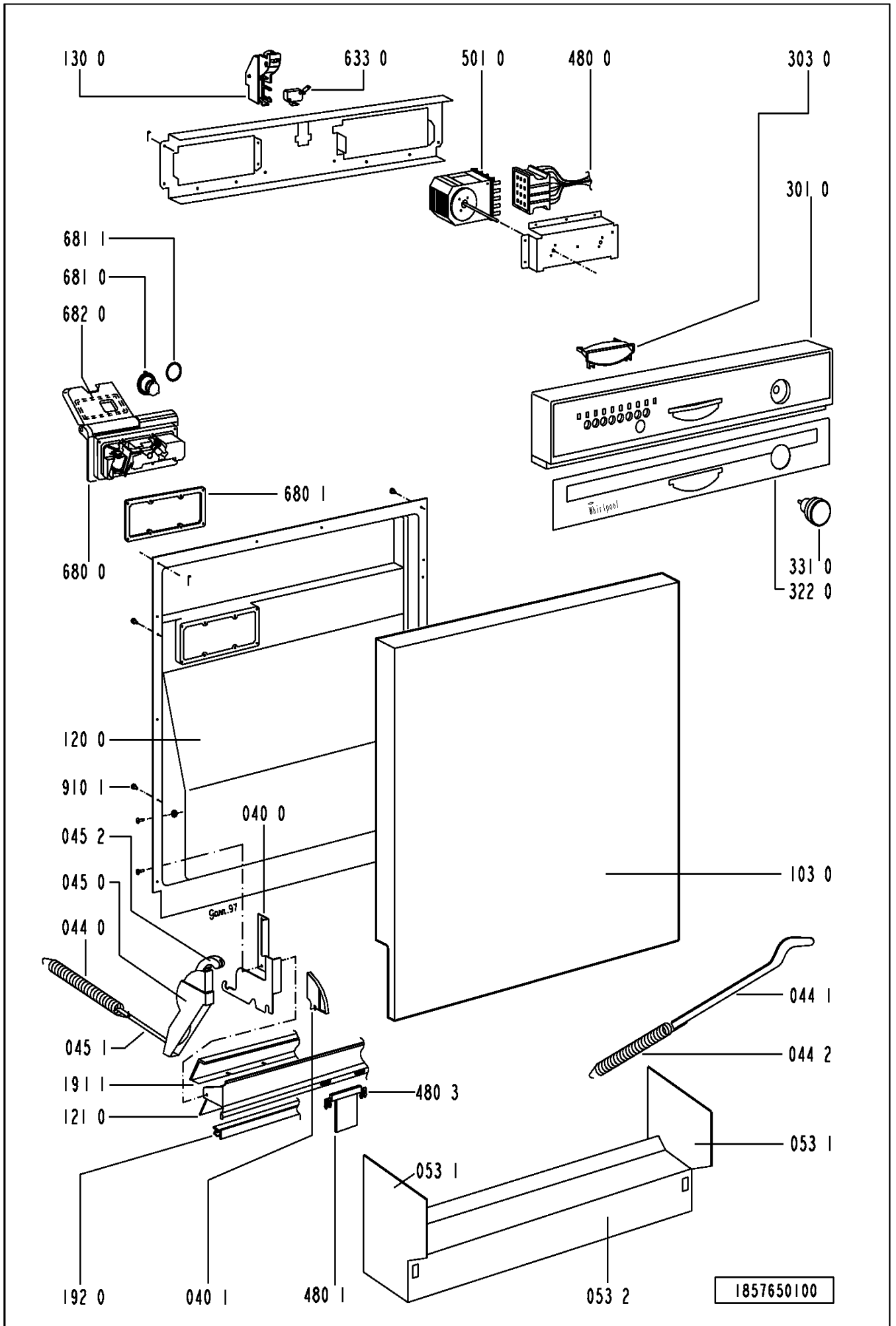

Exploded view

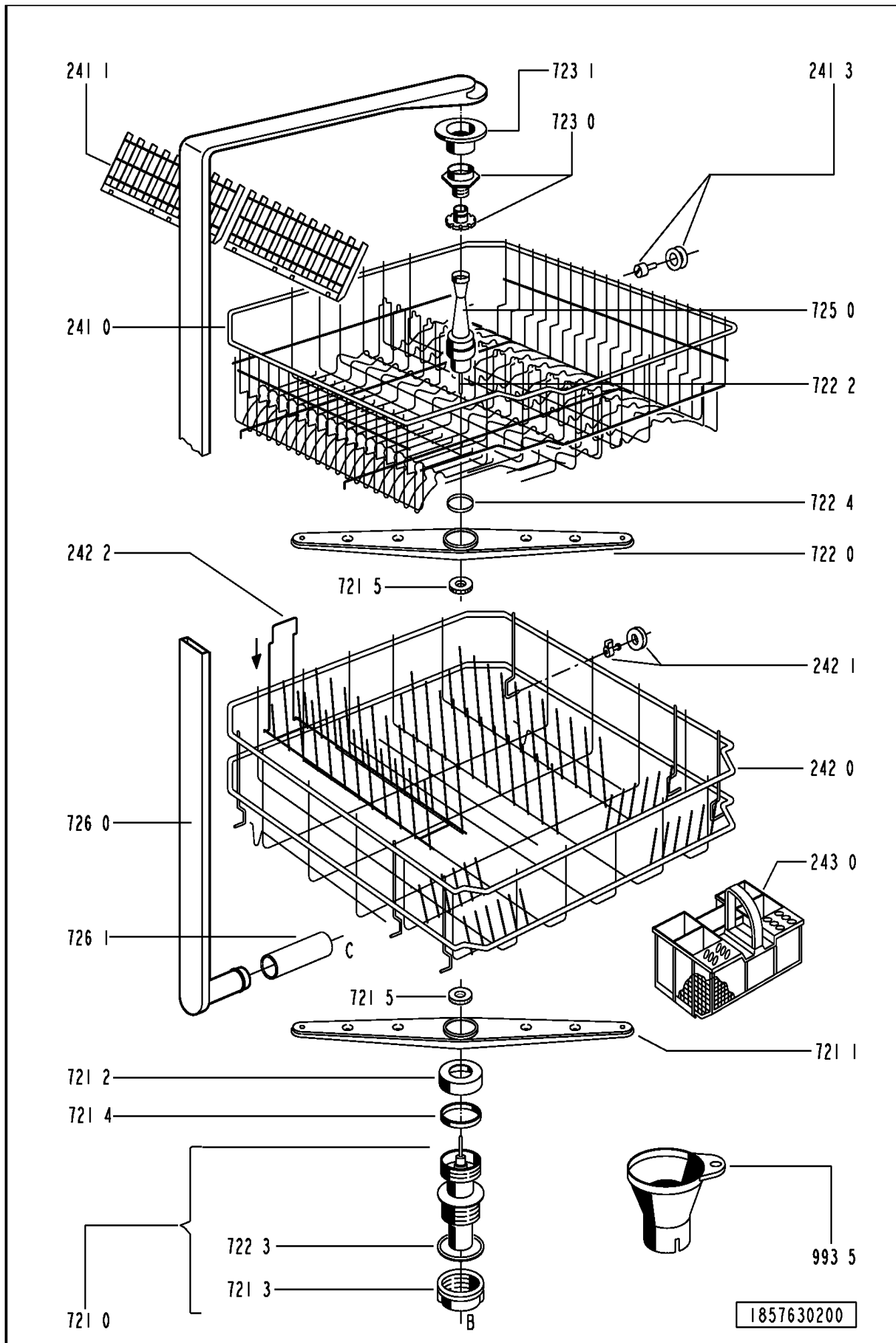

Wiring diagram

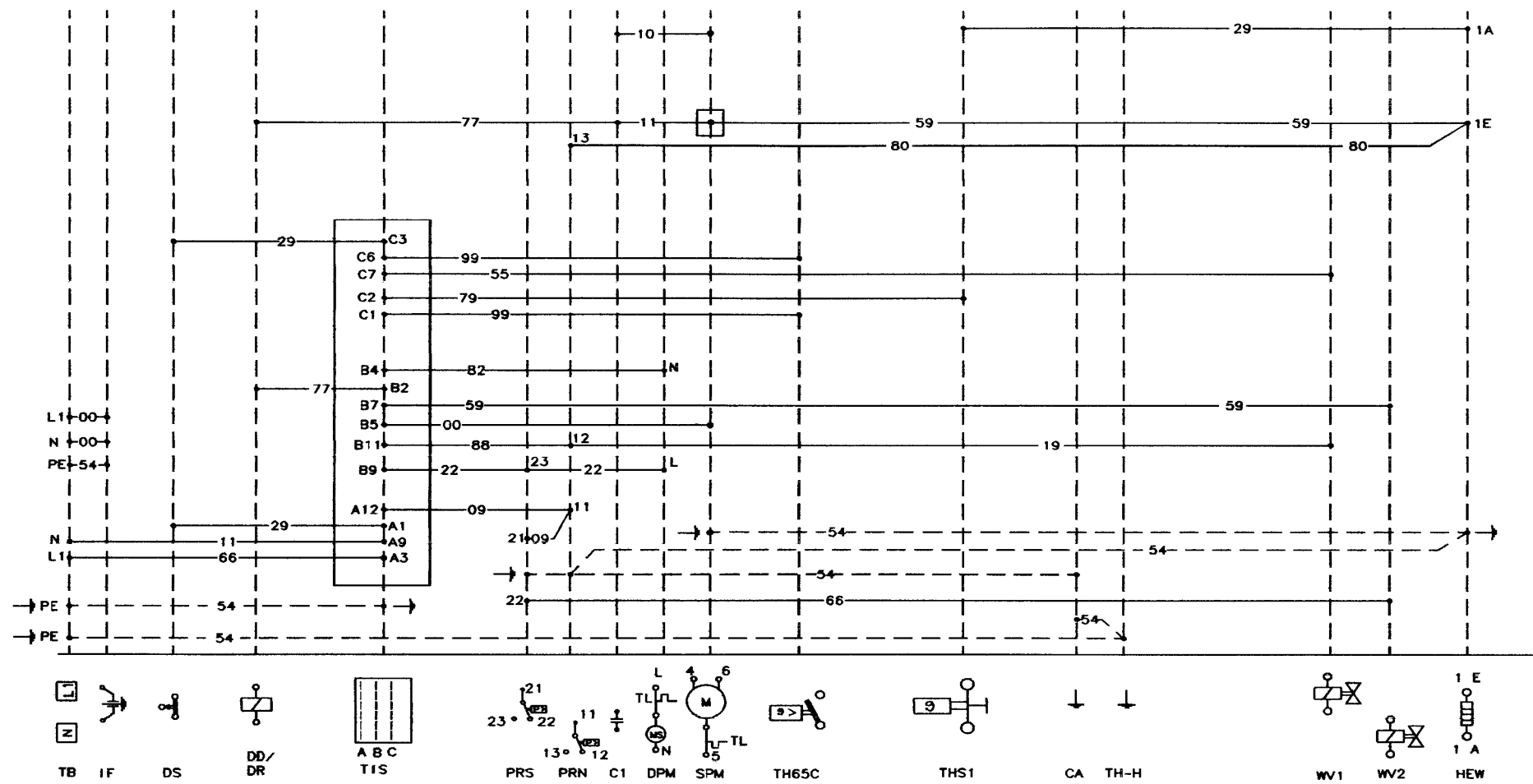

00	black	21	red-brown	34	orange-yellow	66	blue	82	grey-red
09	black-white	22	red	44	yellow	69	blue-white	88	grey
10	brown-black	29	red-white	54	green-yellow	77	violet	99	white
11	brown	31	orange-brown	55	green	79	violet-white		
19	brown-white	33	orange	59	green-white	80	grey-black		

Timer EC 4649.01
1855160200

Circuit diagram

- C1 CAPACITOR
- DD CLEANING AGENT DOSAGE
- DPM DRAINPUMP
- DR RINSE AID DOSAGE
- DS DOOR SWITCH
- HEW HEATER
- IF INTERFERENCE FILTER
- LS6 FLOAT SWITCH
- PP MAIN SWITCH IN TIMER
- PRL BASE LEVEL SWITCH
- PRN WORKING LEVEL SWITCH
- PRS SECURITY LEVEL SWITCH
- PS3 BUTTON FOR RAPID PROGRAM
- SPM PUMP MOTOR
- TB DISTRIBUTION TRIM
- TH/H EARTHING
- TH55 THERMOSTAT 55 °C
- TH65 THERMOSTAT 65 °C
- THS1 SECURITY-THERMOSTAT
- TIS TIMER CONTACT
- TL WINDING PROTECTIVE CONTACT
- TM TIMER MOTOR
- WV1 INLET VALVE
- WV2 REGENERATING VALVE

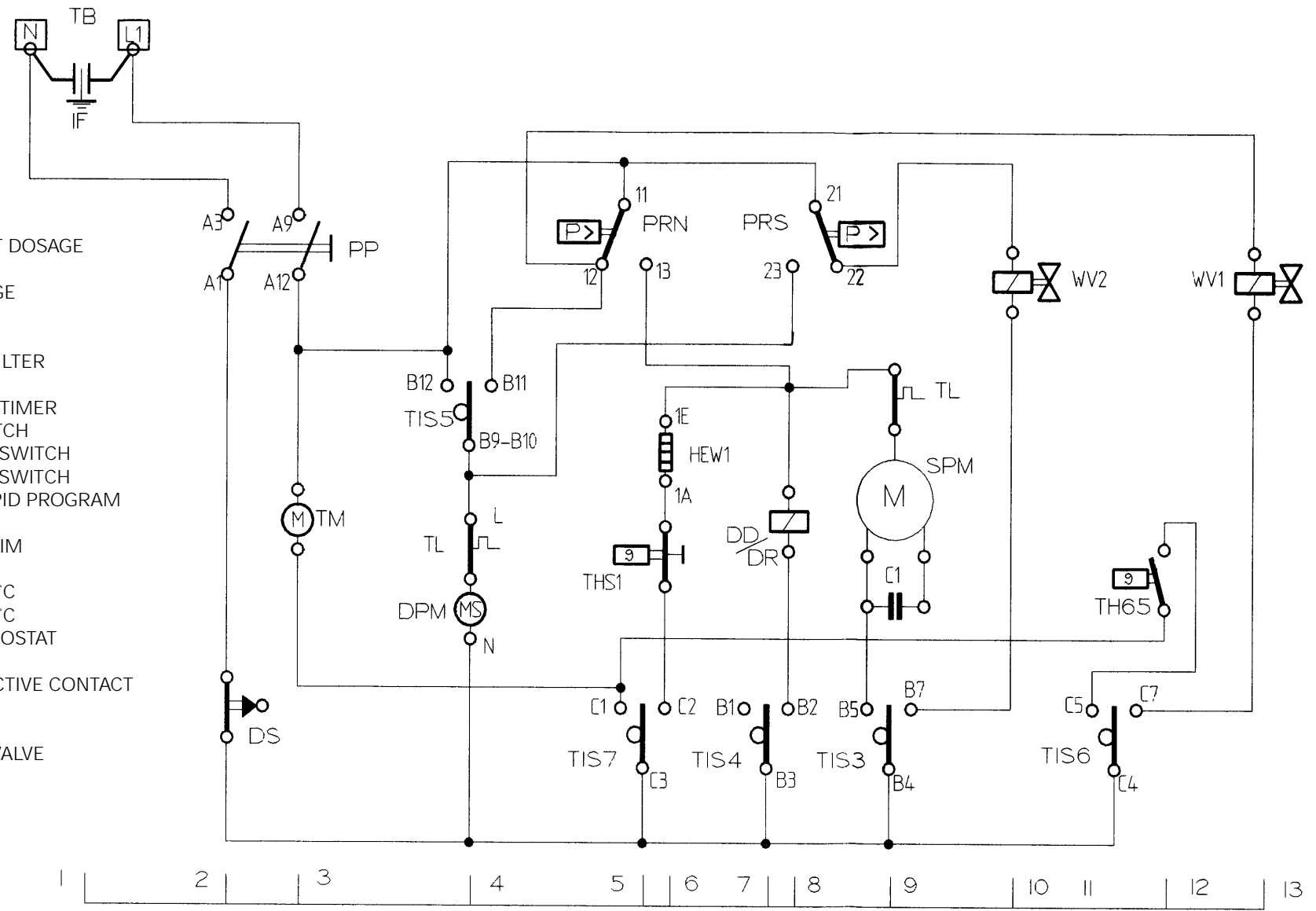

TIMER EC 4649.01
 1855210000

Program diagram

